

Компания Полеель - официальный
дистрибьютор **SANYO**

www.poulel.ru
www.sanyo-airservice.ru

т. (495) 101-30-99

Кондиционеры
Сплит-системы
Полупромышленные кондиционеры
Мультizonальные **VRF** системы кондиционирования
Чиллеры

Contents

	Page
Product Information.....	2
Alert Symbols.....	2
Installation Location.....	3
Electrical Requirements.....	3
Safety Instructions.....	3
Unit display and Operation Controller.....	4
Using the Wireless Remote Controller.....	6
Wireless Remote Controller.....	8
Display (Wireless Remote Controller).....	10
Operation.....	11
Operation without the Wireless Remote Controller.....	12
Special Remarks.....	13
Setting the Timer.....	14
Troubleshooting.....	16
Tips for Energy Saving.....	16

Product Information

If you have problems or questions concerning your Air Conditioner, you will need the following information. Model and serial numbers are on the nameplate on the bottom of the cabinet.

Model No. _____ Serial No. _____

Date of purchase _____

Dealer's address _____

Phone number _____

DECLARATION OF CONFORMITY

This product is marked «**CE**» as it satisfies EEC Directive No. 89/336/EEC, 73/23/EEC and 93/68/EEC.

This declaration will become void in case of mis-usage and/or from non observance though partial of Manufacturer's installation and/or operating instructions.

Alert Symbols

The following symbols used in this manual, alert you to potentially dangerous conditions to users, service personnel or the appliance:



WARNING

This symbol refers to a hazard or unsafe practice which can result in severe personal injury or death.



CAUTION

This symbol refers to a hazard or unsafe practice which can result in personal injury or product or property damage.

Installation Location

- We recommend that this wireless remote controller be installed properly by qualified installation technicians in accordance with the Installation Instructions provided with the unit.
- Before installation, check that the voltage of the electric supply in your home or office is the same as the voltage shown on the nameplate.



WARNING

- Do not install this wireless remote controller where there are fumes or flammable gases, or in an extremely humid space such as a greenhouse.
- Do not install the wireless remote controller where excessively high heat-generating objects are placed.

Avoid:

To protect the air conditioner from heavy corrosion, avoid installing the outdoor unit where salty sea water can splash directly onto it or in sulphurous air near a spa.

Electrical Requirements

1. All wiring must conform to the local electrical codes. Consult your dealer or a qualified electrician for details.
2. Each unit must be properly grounded with a ground (or earth) wire or through the supply wiring.
3. Wiring must be done by a qualified electrician.



CAUTION

To warm up the system, the power mains must be turned on at least five (5) hours before operation. Leave the power mains ON unless you will not be using this appliance for an extended period.

Power mains

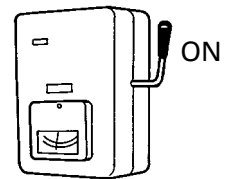

Safety Instructions

- Read this Instruction Manual carefully before using this air conditioner. If you still have any difficulties or problems, consult your dealer for help.
- This air conditioner is designed to give you comfortable room conditions. Use this only for its intended purpose as described in this Instruction Manual.



WARNING

- Never touch the unit with wet hands.
- Never use or store gasoline or other flammable vapor or liquid near the air conditioner — it is very dangerous.
- This air conditioner has no ventilator for intaking fresh air from outdoors. You must open doors or windows frequently when you use gas or oil heating appliances in the same room, which consume a lot of oxygen from the air. Otherwise there is a risk of suffocation in an extreme case.



CAUTION

- Do not turn the air conditioner on and off from the power mains switch. Use the ON/OFF operation button.
- Do not stick anything into the air outlet of the outdoor unit. This is dangerous because the fan is rotating at high speed.
- Do not let children play with the air conditioner.
- Do not cool or heat the room too much if babies or invalids are present.

Unit Display and Operation Controller

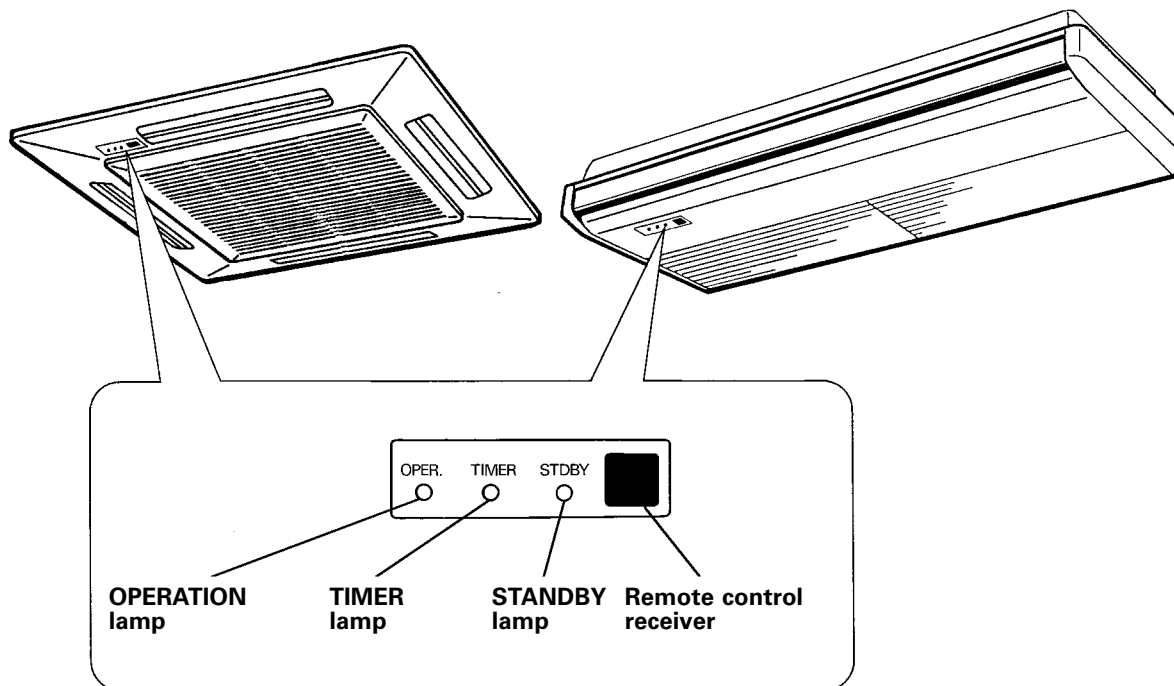

OPERATION lamp	This lamp lights when the appliance is turned on.
TIMER lamp	This lamp lights when the system is being controlled by the timer.
STANDBY lamp	When the unit is in the heating standby condition, the STANDBY lamp lights.
Remote control receiver	This section picks up infrared signals from the wireless remote controller (transmitter).
Operation controller (housed inside)	You can operate this air conditioner using the operation controller without the wireless remote controller.

Unit Display and Operation Controller (continued)

To access the operation controller:

Press on the two latches of the air intake grille with your thumb in the direction of the arrow to open the grille. And open the air intake grille downward. The Operation Controller is located in front of the electrical component box.

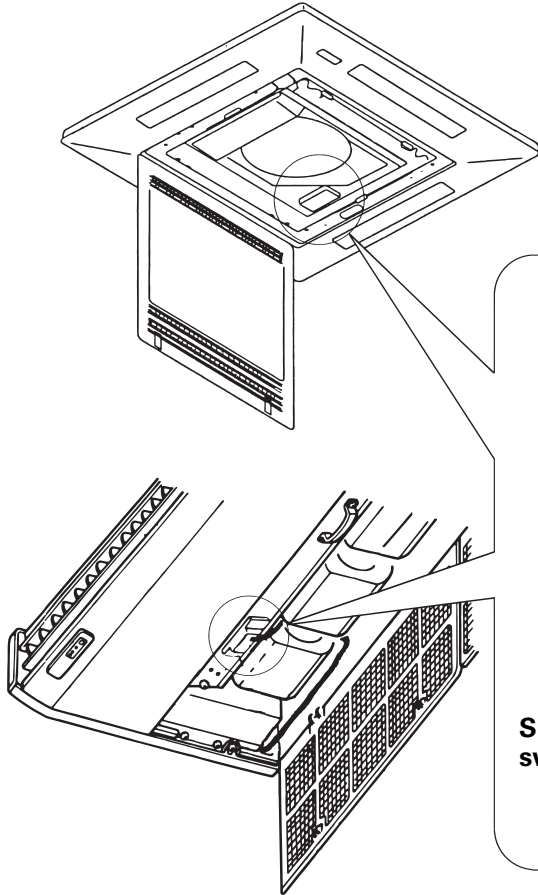

Operation controller

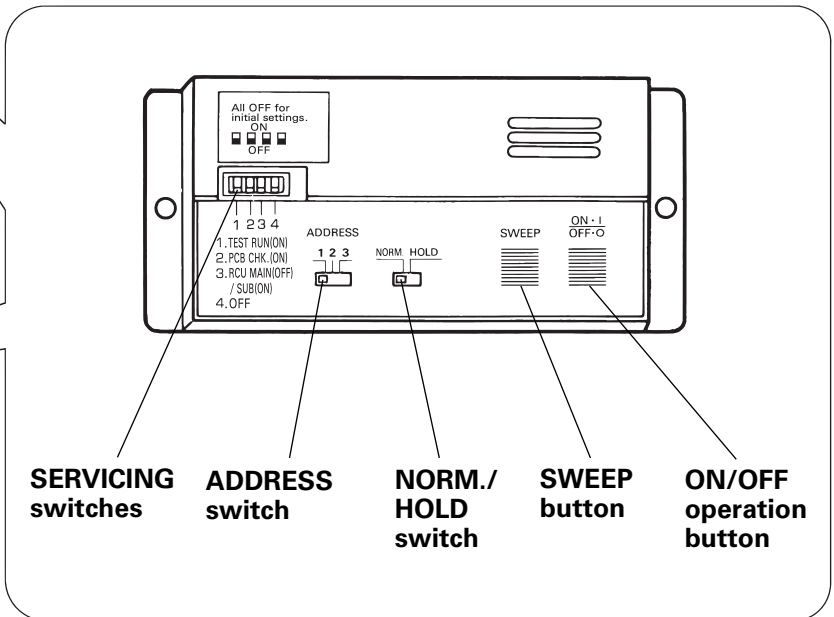

<p>ON/OFF operation button</p>	<p>This button is for turning the air conditioner on and off (automatically setting cooling or heating operation).</p>
<p>SWEEP button</p>	<p>Use this button to make the airflow direction sweep up and down automatically.</p>
<p>NORM./HOLD switch</p>	<p>Usually set this switch in to the NORM. position.</p>
<p>ADDRESS switch</p>	<p>When operating the air conditioner by using the wireless remote controller, be sure to match the number on this switch with the number set on the wireless remote controller. Otherwise, the remote control will not work.</p>
<p>SERVICING switches</p> <p> CAUTION</p>	<p>These switches are used only when servicing the air conditioner. Do not use these SERVICING switches for normal operation.</p>



WARNING

Turning off the ON/OFF operation button does not disconnect the power. Use the main power switch to turn off the power completely.

EG

Using the Wireless Remote Controller

How to Install Batteries

1. Press and slide the lid on the back of the wireless remote controller in the direction of the arrow.
2. Install two AAA alkaline batteries. Make sure the batteries point in the direction marked in the battery compartment.
3. Press the ACL button, then replace the lid.
If you press it, the current time, ON time, and OFF time are all reset to 0:00.

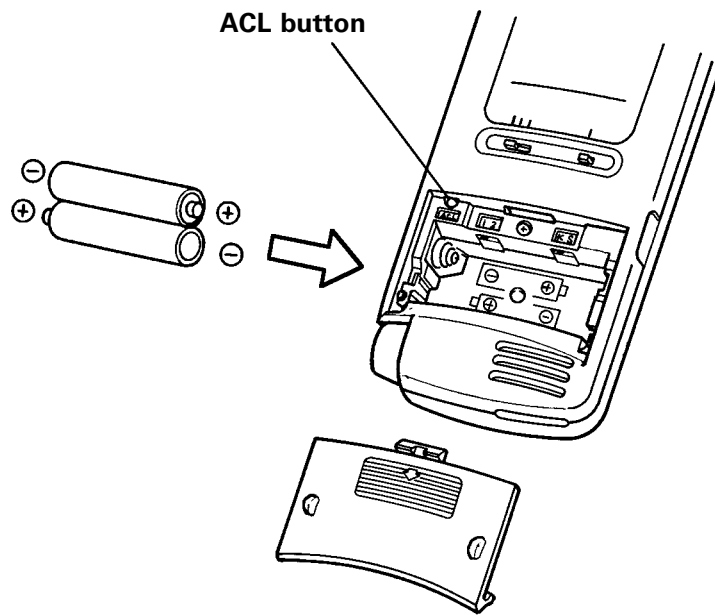

CAUTION

- The batteries last about six months, depending on how much you use the wireless remote controller. Replace the batteries when the wireless remote controller's lamp fails to light, or when the wireless remote controller cannot be used to change the air conditioner's setting.
- Use two fresh leak-proof type-AAA alkaline batteries.
- In replacing batteries, follow the instructions as mentioned in the sub-section "How to Install Batteries".
- If you do not use the wireless remote controller more than 1 month, take out the batteries.

Using the Wireless Remote Controller (continued)

How to Use the Wireless Remote Controller

When using the wireless remote controller, always point the unit's transmitter head directly at the air conditioner's receiver.

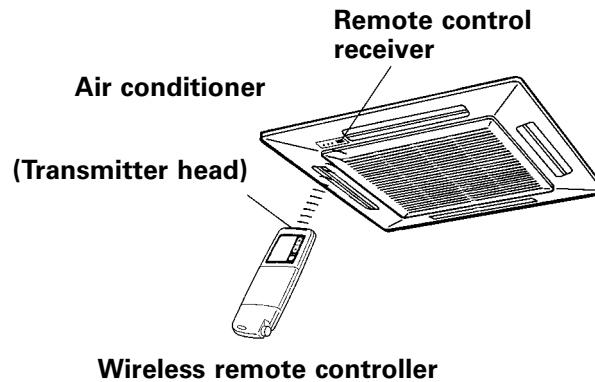

Wireless Remote Controller Installation Position

The wireless remote controller can be operated from either a non-fixed position or a wall-mounted position.

To ensure that the air conditioner operates correctly, do not install the wireless remote controller in the following places:

- In direct sunlight
- Behind a curtain or other place where it is covered
- More than 8 m away from the air conditioner
- In the path of the air conditioner's airstream
- Where it may become extremely hot or cold
- Where it may be subject to electrical or magnetic interference

1. If Non-fixed Position

Raise the rear plate of the wireless remote controller mounting cradle and insert the wireless remote controller. The unit can be used either in that position (placed on a table, for instance) or held in the hand.

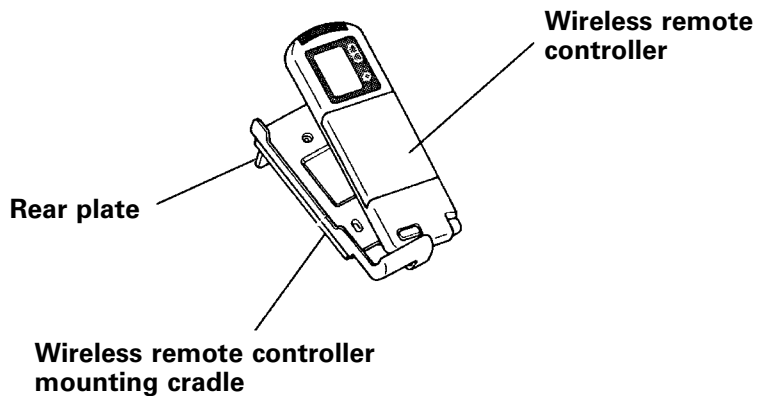

2. If Wall-mounted Fixed Position

Install the wireless remote controller at a convenient location on a nearby wall. However, before attaching the wireless remote controller mounting cradle, check that the wireless remote controller can operate from the desired wall position.

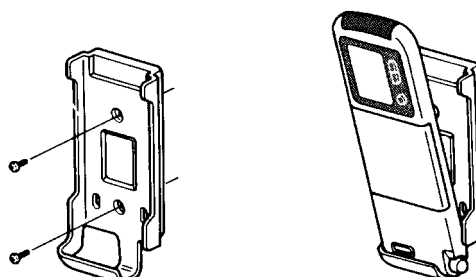

Wireless Remote Controller

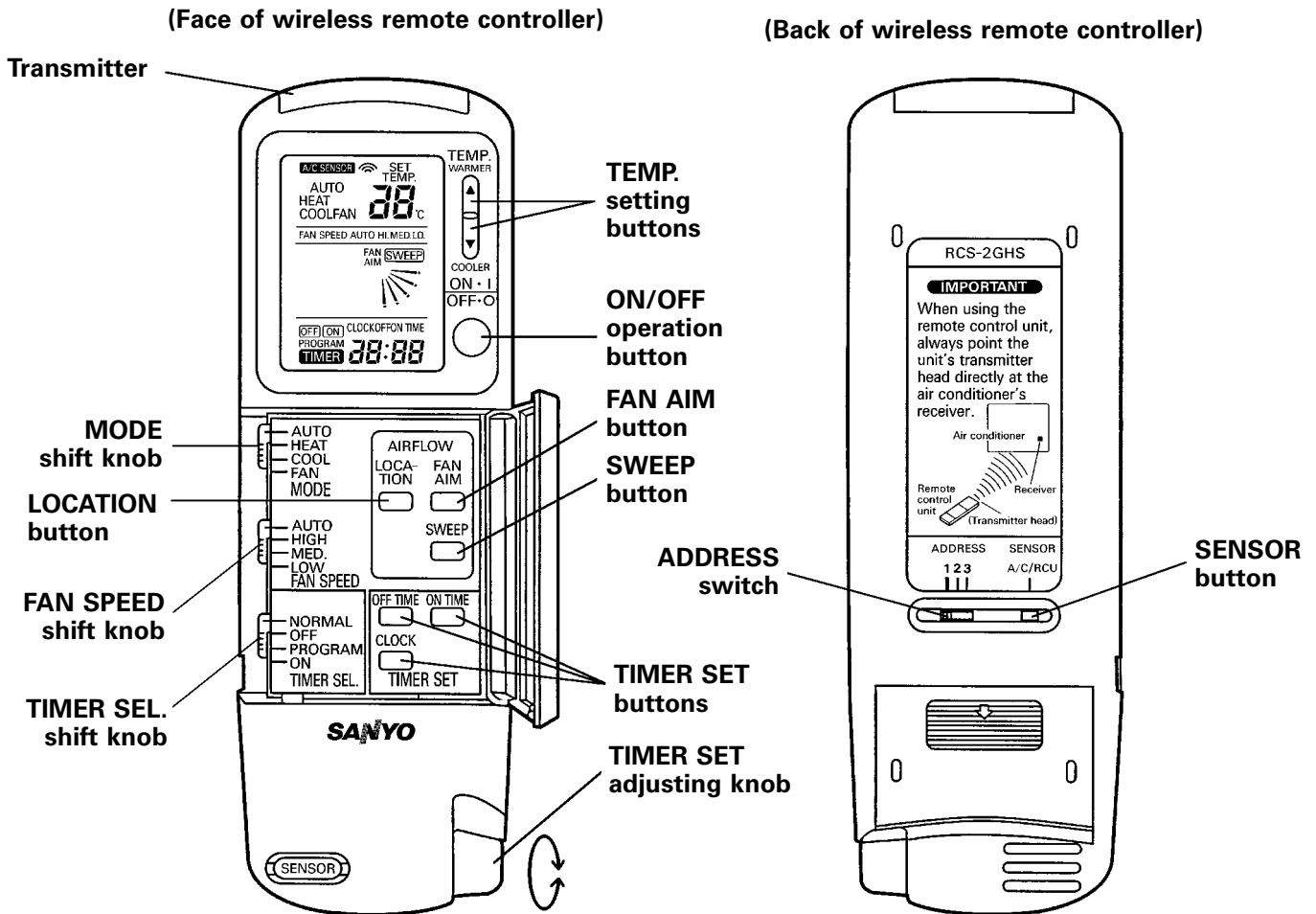

ON/OFF operation button	This button is for turning the air conditioner on and off.
MODE shift knob	Use this shift knob to select one of the following four operations: AUTO: Used to automatically set cooling or heating operation. (temperature range: 17 ~ 27 °C) HEAT: Used for normal heating operation. (temperature range: 16 ~ 26 °C) COOL: Used for normal cooling operation. (temperature range: 18 ~ 30 °C) FAN: Used to run the fan only, without the heating or cooling operation.
TEMP. setting buttons	WARMER ▲ : Press this button to increase the temperature setting. COOLER ▼ : Press this button to decrease the temperature setting.
FAN SPEED shift knob	AUTO: The air conditioner automatically decides the fan speed. HIGH : High fan speed MED. : Medium fan speed LOW : Low fan speed
TIMER SEL. shift knob	Use this shift knob while the unit is operating to switch between timer settings. NORMAL: Used for normal operation. OFF: The air conditioner stops at the set time. PROGRAM: The air conditioner stops and starts, or starts and stops, at the set times every day. ON: The air conditioner starts at the set time.

Wireless Remote Controller (continued)

<p>FAN AIM button</p>  <p>CAUTION</p>	<p>Use this button to set the airflow direction* to a specific angle: * The airflow direction is displayed on the wireless remote controller.</p> <table border="1" data-bbox="603 344 1385 488"> <thead> <tr> <th><u>Operation mode</u></th> <th><u>Number of airflow direction settings.</u></th> </tr> </thead> <tbody> <tr> <td>COOL</td> <td>3</td> </tr> <tr> <td>HEAT or FAN</td> <td>5</td> </tr> <tr> <td>AUTO</td> <td>3</td> </tr> </tbody> </table> <ul style="list-style-type: none"> • In the cool mode, if the flaps are set in a downward position, condensation may form and drip around the vent. • Do not move the flap with your hands. 	<u>Operation mode</u>	<u>Number of airflow direction settings.</u>	COOL	3	HEAT or FAN	5	AUTO	3
<u>Operation mode</u>	<u>Number of airflow direction settings.</u>								
COOL	3								
HEAT or FAN	5								
AUTO	3								
<p>SWEEP button</p>	<p>Use this button to make the airflow direction sweep up and down automatically (airflow direction is displayed).</p>								
<p>TIMER SET buttons</p>	<p>OFF TIME: Press this button to set the off time and then use the TIMER SET adjusting knob to adjust the time.</p> <p>ON TIME: Press this button to set the on time and then use the TIMER SET adjusting knob to adjust the time.</p> <p>CLOCK: Press this button to set the present time and then use the TIMER SET adjusting knob to adjust the real time.</p>								
<p>TIMER SET adjusting knob</p>	<p>Use this knob to adjust the present time or timer setting. (For details, see "Setting the Timer.")</p>								
<p>ADDRESS switch</p>	<p>Match this ADDRESS NO. with the indoor unit ADDRESS NO. (on the operation controller in the indoor unit).</p>								
<p>SENSOR button</p>	<p>Room temperature sensors are contained in both the indoor unit and the wireless remote controller. You can select only one side.</p> <p>A/C: The room temperature sensor in the indoor unit is used. The A/C SENSOR indicator in the display on the wireless remote controller appears.</p> <p>RCU: The room temperature sensor in the wireless remote controller is used. The A/C SENSOR indicator disappears.</p>								
<p>Transmitter</p>	<p>When you press the buttons or move the switches on the wireless remote controller, the indicator on the display of the wireless remote controller flashes to transmit the setting changes to the receiver in the air conditioner.</p>								
<p>LOCATION button</p> <p>NOTE</p>	<p>Although the wireless remote controller has LOCATION button, this mode cannot be selected with this model.</p>								

Display (Wireless Remote Controller)

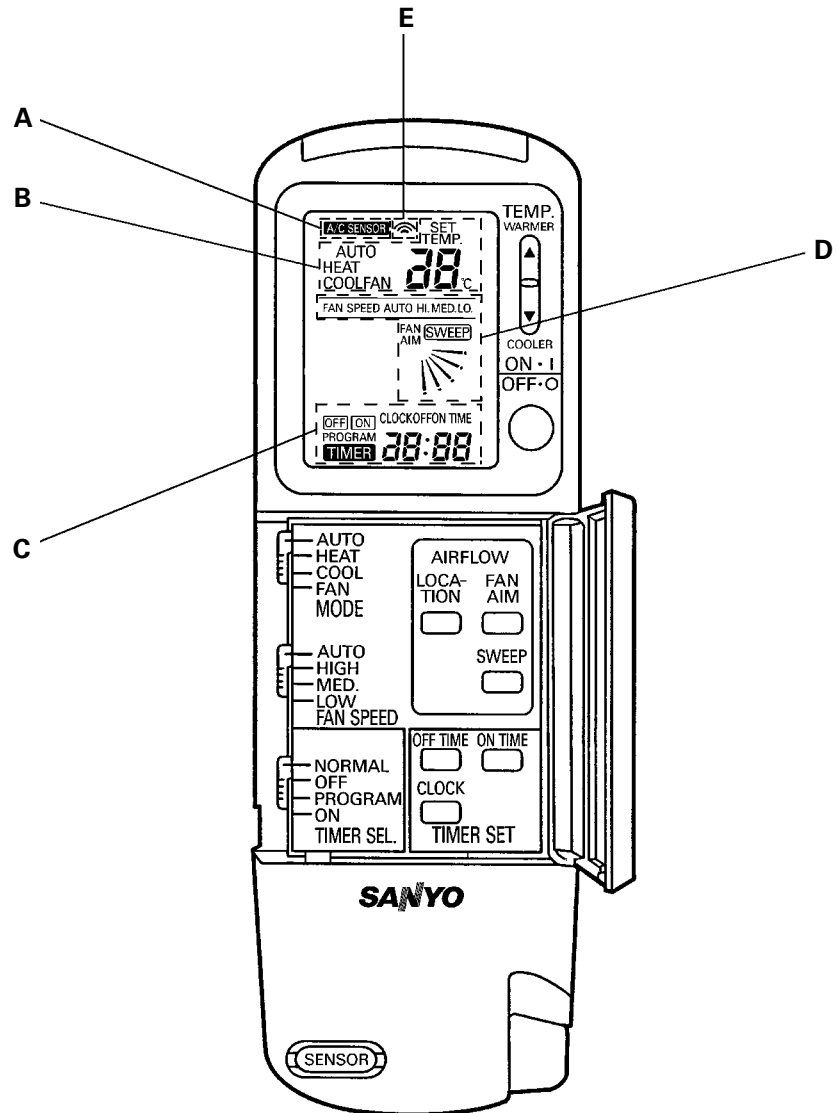

Description

- A:** When you press the SENSOR button on the back of the wireless remote controller, the A/C SENSOR indicator appears or disappears.
- B:** The currently selected operation mode is displayed.
- C:** When the unit is turned off, the current time is displayed. When the unit is turned on, the current time and selected timer mode are displayed.
- D:** The currently selected FAN SPEED, FAN AIM and SWEEP status are displayed.
- E:** This indicator flashes when you operate the wireless remote controller.

Operation

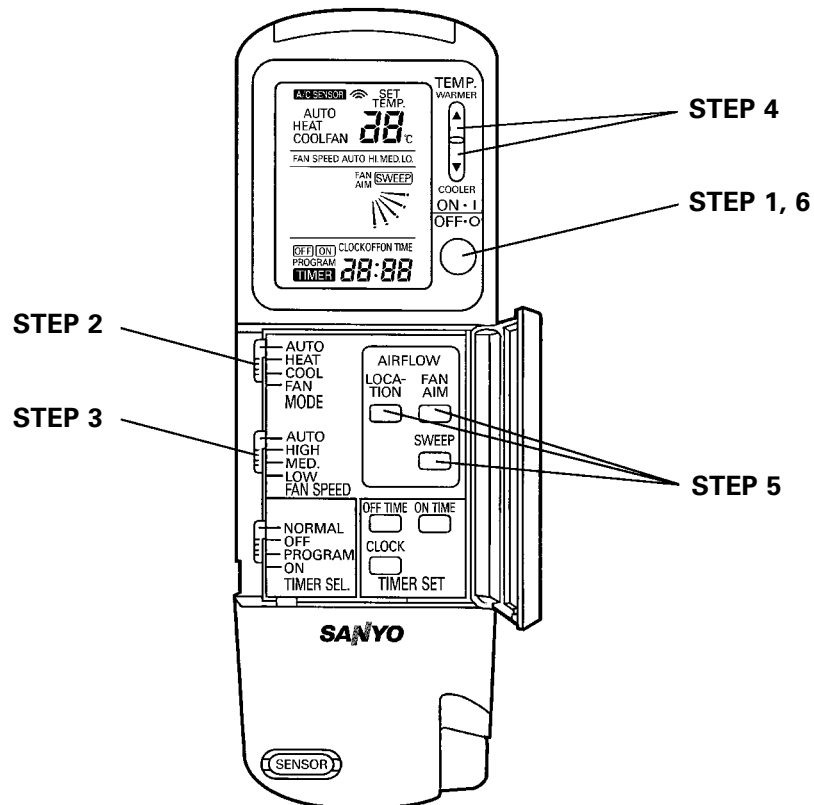

NOTE

To warm up the system, the power mains must be turned on at least five (5) hours before operation.

- STEP 1 To start the air conditioner**
Press the operation button. (ON/OFF button)
- STEP 2 Setting the mode**
Set the MODE shift knob to select the mode of your choice. (AUTO, HEAT, COOL or FAN)
- STEP 3 Setting the fan speed**
Set the FAN SPEED shift knob to select the fan speed of your choice. (AUTO*, HIGH, MED. or LOW)
* If AUTO is selected, the fan speed switches automatically.
- STEP 4 Setting the temperature**
Use the COOLER or WARMER button as appropriate to change the temperature setting as desired. (COOLER reduces the temperature, and WARMER increases the temperature.)
- STEP 5 Setting the airflow direction**
* To adjust the airflow direction press either the FAN AIM or SWEEP button, as appropriate. (Use the FAN AIM button to set the airflow direction, and the SWEEP button to circulate air.)
- STEP 6 To stop the air conditioner**
Press the operation button (ON/OFF button) again.

IMPORTANT

- Choose the best position in the room for the wireless remote controller, which also acts as the sensor for room comfort and transmits the operating instructions. Once you've found this best position, always keep the wireless remote controller there.
- To prevent the appliance from malfunctioning, do not set any selector switch between two indicated positions. Make sure that it clicks into position.
- This appliance has a built-in 3-minute time delay circuit to ensure reliable operation. If the operation button is pressed, the compressor will start running after three minutes. In the event of a power failure, the unit will stop. When power is restored, the unit will re-start automatically after three minutes.

EG

Operation without the Wireless Remote Controller

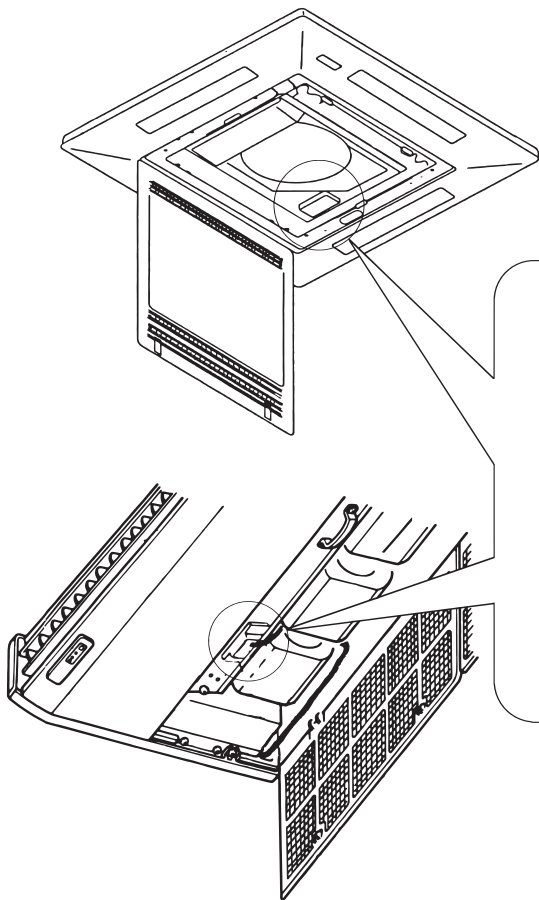

Operation controller

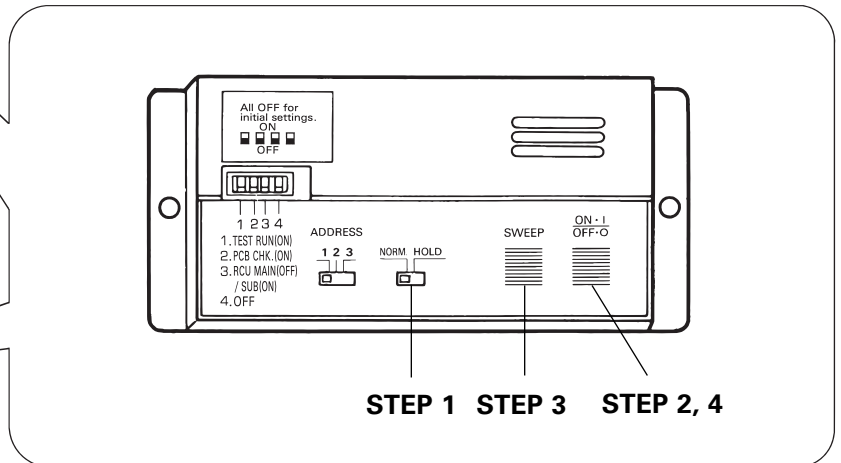

If you have lost the wireless remote controller or if it is not working properly, follow the steps below:

- STEP 1** Set the NORM./HOLD switch to the HOLD position and then set it back to the NORM. position again.
- STEP 2** **To start the air conditioner**
Press the ON/OFF operation button (automatically setting cooling or heating operation).
- STEP 3** **Setting the airflow direction**
To adjust the airflow direction, press the SWEEP button as appropriate. You can only set the airflow for all four sides in the same direction, or have each sweep.
- STEP 4** **To stop the air conditioner**
Press the ON/OFF operation button again.

Special Remarks

Heating Operation

Heating performance

- Because this appliance heats a room by utilizing the heat of the outside air (heat pump system), the heating efficiency will fall off when the outdoor temperature is very low. If sufficient heat cannot be obtained with this heat pump, use another heating appliance in conjunction with this unit.

Defrosting

- When the outdoor temperature is low, frost or ice may form on the outdoor heat exchanger coil, reducing the heating performance. When this happens, a microcomputer-controlled defrosting system operates. At the same time, the fan on the indoor unit stops (or runs at very low speed in some cases) and the "STDBY" lamp lights on the indoor unit until defrosting is completed. Heating operation then restarts after several minutes. (This interval will vary slightly depending upon the outdoor temperature and the way in which frost forms.)

"STDBY" lamp on the indoor unit

- For several minutes after the start of heating operation, the indoor fan will not start running (or it will run at very low speed in some cases) until the indoor heat exchanger coil has warmed up sufficiently. This is because a cold draft prevention system is operating. During this period, the "STDBY" lamp remains lit.
- "STDBY" lamp remains lit during defrosting or when the compressor has been turned off (or when the unit is running at very low speed) by the thermostat when the system is in the heating mode.
- Upon completion of defrosting and when the compressor is turned on again, "STDBY" lamp will light off automatically as the heating operation resumes.

ADDRESS switch setting

When setting up two or three air conditioners in one room, you can control the air conditioners correctly by setting the ADDRESS switches of the Operation Controllers and the Wireless Remote Controllers.

You can control the air conditioners:

- 1) with one wireless remote controller changing the ADDRESS switch setting of the wireless remote controller.
- 2) with each wireless remote controller having the ADDRESS switch set differently.

NOTE

Should the power fail while the unit is running

- If the power supply for this unit is temporarily interrupted the unit will automatically resume operation (once the power is restored) with the same settings that were in effect before the power was interrupted.
- Be sure to place the wireless remote controller where it can operate the air conditioner correctly.

EG

Setting the Timer

TIMER OFF

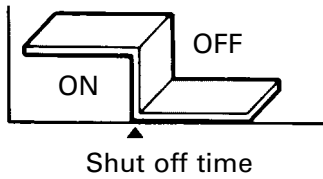

Use this mode to turn off the appliance automatically at the desired time.

TIMER ON

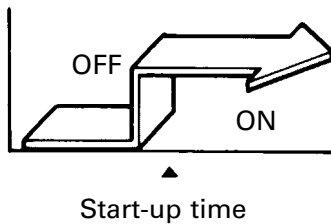

Use this mode to start the appliance automatically at the desired time.

PROGRAM TIMER

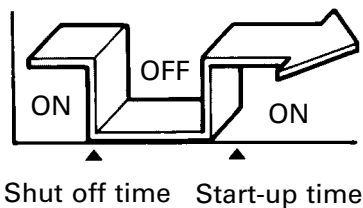

Use this mode to turn the appliance on and off automatically at the same set times every day.

NOTE

Because this timer uses the actual time of day, be sure that the clock is set to the correct time.

How to set the present time

(Example) To set the time to 21:10



Operation

1. Press the CLOCK button to select CLOCK mode.
2.
 - Turn the TIMER SET adjusting knob clockwise or counterclockwise until 21:10 is displayed.
 - Press the CLOCK button again to set the present time.

Indication

- ➡ The time indication alone flashes.
- ➡ The display will automatically stop flashing (except for the ":" symbol) after 10 sec.

How to use the OFF timer

(Example) To stop the air conditioner at 23:30



Operation

1. Press the ON/OFF operation button to start the air conditioner.
2. Press the OFF TIME button to select OFF TIME mode.
3. Turn the TIMER SET adjusting knob clockwise or counter-clockwise until 23:30 is displayed.
4. Press the OFF TIME button to set the off time.
5. Set the TIMER SEL. shift knob to the OFF position.

Indication

- ➡ The timer OFF and time indications flash.
- ➡ The display will automatically change back to the present time after 10 sec.

How to use the ON timer

(Example) To start the air conditioner at 7:10



Operation

1. Press the ON/OFF operation button to start the air conditioner.
2. Press the ON TIME button to select ON TIME mode.
3. Turn the TIMER SET adjusting knob clockwise or counter-clockwise until 7:10 is displayed.
4. Press the ON TIME button to set the on time.
5. Set the TIMER SEL. shift knob to the ON position.

Indication

- ➡ The timer ON and time indications flash.
- ➡ The display will automatically change back to the present time after 10 sec.

NOTE

When the ON timer is set, the unit enters the paused state. The operation lamp stays lit, indicating that the unit is waiting until the set time comes.

How to use the PROGRAM timer

(Example) To start operation at 7:10 and stop at 23:30

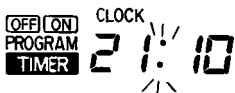

Operation

1. Press the ON/OFF operation button to start the air conditioner.
2. Set the TIMER ON/OFF times as shown in the above procedures.
3. Set the TIMER SEL. shift knob to the PROGRAM position (ON/OFF combination*).

* At this point, the setting (ON or OFF) that is closer to the current time is displayed; when that time comes, the next PROGRAM indicator (ON or OFF) is displayed.

• Checking the timer setting

When the OFF TIME or ON TIME button is pressed, the timer setting is displayed. After a pause, the display changes to the clock display.

Troubleshooting

If your air conditioner does not work properly, first check the following points before requesting service. If it still does not work properly, contact your dealer or a service center.

Trouble	Possible Cause	Remedy
Air conditioner does not run at all.	<ol style="list-style-type: none"> 1. Power failure 2. Leakage breaker has tripped. 3. Line voltage is too low. 4. Operation button is OFF. 5. The wireless remote controller or heat pump is malfunctioning. 6. Batteries in wireless remote controller have run down. 	<ol style="list-style-type: none"> 1. Restore power. 2. Contact service center. 3. Consult your electrician or dealer. 4. Press the button again. 5. Consult your dealer. 6. Replace batteries.
Compressor runs but soon stops.	<ol style="list-style-type: none"> 1. Obstruction in front of condenser coil 	<ol style="list-style-type: none"> 1. Remove obstruction.
Poor cooling (or heating) performance	<ol style="list-style-type: none"> 1. Dirty or clogged air filter 2. Heat source or many people in room 3. Doors and/or windows are open. 4. Obstacle near air intake or air discharge port 5. Thermostat is set too high for cooling (or too low for heating). 6. (Outdoor temperature is too low). 7. (Defrosting system does not work.) 	<ol style="list-style-type: none"> 1. Clean the air filter to improve the airflow. 2. Eliminate heat source if possible. 3. Shut them to keep the heat (or cold) out. 4. Remove it to ensure good airflow. 5. Set the temperature lower (or higher). 6. (Try to use a back-up heater.) 7. (Consult your dealer.)
Lamps on the indoor unit are flashing.	<ol style="list-style-type: none"> 1. Trouble in wiring system 	<ol style="list-style-type: none"> 1. Contact service center.

Tips for Energy Saving

- Avoid**
- **Do not block the air intake and outlet of the unit. If either is obstructed, the unit will not work well, and may be damaged.**
 - Do not let direct sunlight into the room. Use sunshades, blinds or curtains. If the walls and ceiling of the room are warmed by the sun, it will take longer to cool the room.
- Do**
- Always try to keep the air filter clean. A clogged filter will impair the performance of the unit.
 - To prevent conditioned air from escaping, keep windows, doors and any other openings closed.

NOTE

Should the power fail while the unit is running

If the power supply for this unit is temporarily interrupted the unit will automatically resume operation (once the power is restored) with the same settings that were in effect before the power was interrupted.